

Internal Brake Roller (BR80)

- Suitable for wooden pallets, plastic pallets.



Dimensional Drawing

BR80

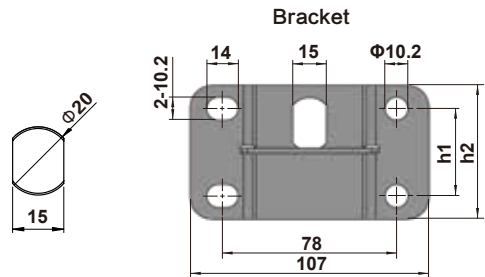
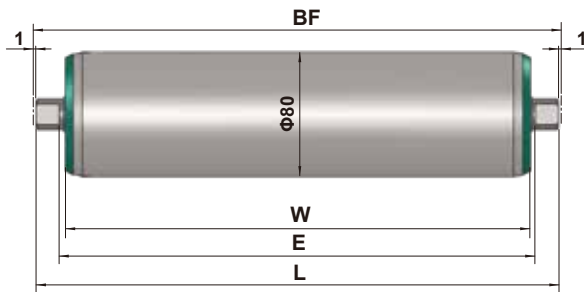

brackets 2pcs, bolts & nuts 8 sets

Model	h1	h2
80-55	30.3	55
80-60	39	60

Model	D*T	L Min mm	L Max mm			
BR80/AA	80x2.5	265	1350	BF=L+2	E=L-30	W=L-38
BR80/BA	80x2.5	340	1350	BF=L+2	E=L-30	W=L-38
BR80/AS	80x2.5	265	1350	BF=L+2	E=L-30	W=L-38

Specifications

Model	D*T	Shaft	Weight Range	Tube	
				Steel, zinc plated	Steel, zinc plated, knurled surface
BR80/AA	80x2.5	b/h = 15/20	200-1000kg	√	√
BR80/BA			1000-1500kg	√	√
BR80/AS		Milled Flats	200-1000kg	√	√

☆ Knurled surface for better frictional force.

*BR80/AS is suitable for LIFO push-back.

Part No.

BR	80	/	A	A	—	20	—	Z	—	1248
Model	OD		Object Weight	Direction of Rotation		Shaft Dia.		Tube		L dimension (mm)
BR	80		A : 200~1000kgs B : 1000~1500kgs	A:Standard B:Single Direction		20:Milled Flats		Z:Steel, zinc plated K:Knurled surface		

Installation Instructions



1. Fix one bracket (opening socket upward) with bolts and nuts at the inner side of rack.
2. Put milled flat in opening socket of fixed bracket, put the other end into another bracket, fix it at the inner side of rack with bolts and nuts.
3. Brake roller's surface should be above gravity rollers' surface 1–2mm to ensure the speed controlling effect.

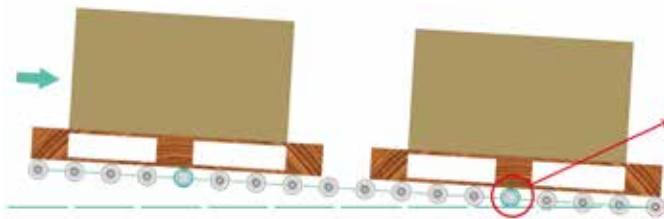

Direction of arrow on the end cap should be the same as brake roller's rotate direction



*Wrong install direction will cause goods outrush risk by brake roller malfunction.

Suggestion

1. Gravity roller rack's slope range as 1.5° ~ 2.3° . Pallet weight please check specifications table.
2. Installation pitch of brake rollers should be as the length of the pallet, no impact or accelerated speed is permitted.
3. Pitch of adjacent brake rollers should be less than the depth of pallet in flow direction, avoid accelerated speed and impact during flowing.
4. Please apply few brake rollers in actual weight and slope on gravity rack for test before bulk installation.
5. When you meet special application (heavy weight big slope or light weight small slope), please contact us for consultation.

*Environmental Temperature: -5°C ~ $+40^{\circ}\text{C}$, Humidity: 30% ~ 70% RH without condensation.